

38° 20' 29.5" 32  
 127 09 9.9 12  
 144 30 14.2 16

53.5  
 0.5  
 (29)

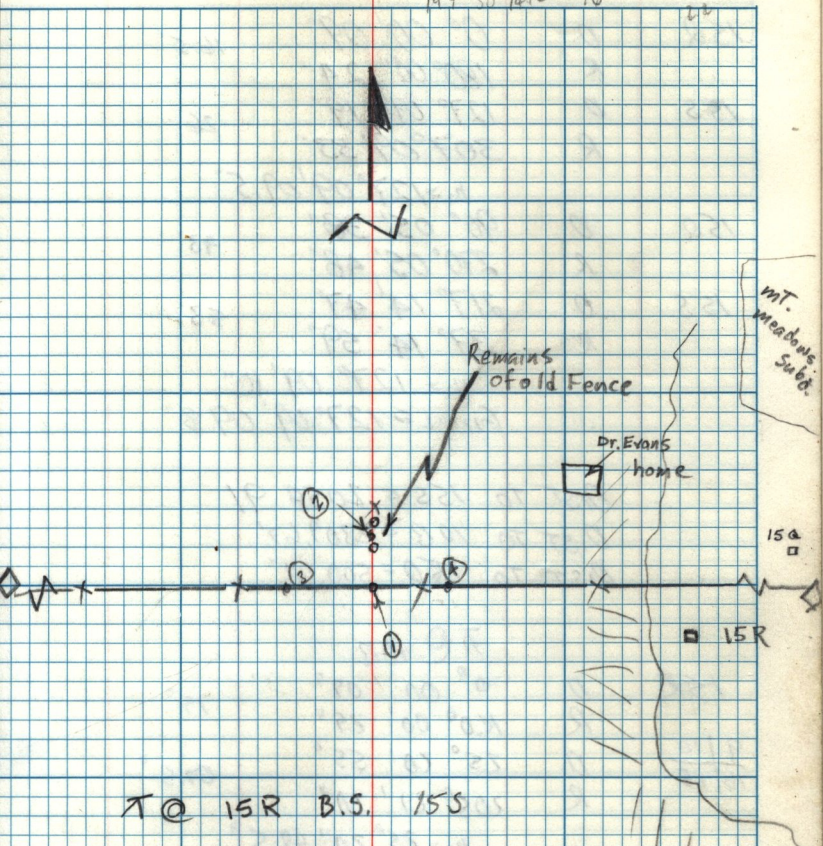

T @ 15R B.S. 155

4 RT  $59^{\circ} 16' 36''$   
 Dist. 565.59' to ①

2 RT  $62^{\circ} 59' 45''$   
 Dist. 565.55' to ②

4 RT  $59^{\circ} 11' 30''$   
 Dist. 615.54' to ③

4 RT  $59^{\circ} 35' 26''$   
 Dist. 459.48' to ④